



2016 Regional Transportation Alternatives Program (TAP) Grant Application

PROJECT

TITLE: Fort Stevens Elementary - Pedestrian Improvements

GENERAL PROJECT INFORMATION

Agency or Organization City of Yelm

Contact Person Chad Bedlington, PW Director

Phone Number (360) 458 - 8412

Email Address chadb@ci.yelm.wa.us

Type of Transportation Partner **Select One**

Traditional Transportation Partner

Non-Traditional Transportation Partner

Threshold Criteria (check all that apply)

	Yes	No
Project elements meet all regional eligibility requirements	<input checked="" type="radio"/>	<input type="radio"/>
Project elements and administration meet all federal eligibility requirements	<input checked="" type="radio"/>	<input type="radio"/>
Applicant can demonstrate ability to obligate funding as proposed	<input checked="" type="radio"/>	<input type="radio"/>

STATUS OF EXISTING FEDERAL PROJECTS

Does the applicant have any other regionally selected projects underway? (yes or no) Yes No

Does the applicant have any other state selected federal projects underway? (yes or no) Yes No

If yes to either, attach separate documentation describing status of each project including project name, funding source, year of award, progress to date, future obligation commitments and strategy for meeting those obligation commitments in addition to those associated with new project funding.

PROJECT INFORMATION

Applicant's Project Priority

Are you submitting more than one TAP application (3 maximum)? Yes No

If "Yes," what priority is this project application? of

TYPE OF PROJECT OR PROGRAM

(Identify one "Primary Purpose" and any "Secondary Purpose" project type that applies)

	Primary	Secondary
Safe Routes to School project or program	<input checked="" type="radio"/>	<input type="checkbox"/>
Provision of facilities for pedestrians and/or bicycles	<input type="radio"/>	<input checked="" type="checkbox"/>
Preservation and/or conversion of abandoned railway corridors for bike/ped trails	<input type="radio"/>	<input type="checkbox"/>
Construction of turnouts, overlooks, and viewing areas	<input type="radio"/>	<input type="checkbox"/>
Recreational Trails Program (Section 206 of title 23)	<input type="radio"/>	<input type="checkbox"/>
Inventory, control and removal of outdoor advertising	<input type="radio"/>	<input type="checkbox"/>
Preservation & rehabilitation of historic transportation buildings, structures, facilities	<input type="radio"/>	<input type="checkbox"/>
Vegetation management in ROW to control invasive species or control erosion	<input type="radio"/>	<input type="checkbox"/>
Archaeological activities related to impacts from transportation projects	<input type="radio"/>	<input type="checkbox"/>
Environmental mitigation to address stormwater associated with highway runoff	<input type="radio"/>	<input type="checkbox"/>
Environmental mitigation to reduce wildlife mortality or improve habitat connectivity	<input type="radio"/>	<input type="checkbox"/>

PROJECT OVERVIEW

Brief abstract (~ 150 words) of proposal identifying problem or need, how the proposal will address it, and anticipated benefits. This is a high level summary suitable for reports and on-line descriptions. Detailed project information is provided on page 3.

The project will improve safety for students and pedestrians along 100th way southeast and grove road near Fort Stevens Elementary. The existing roadway offers no protection from vehicles passing by or turning movements. There is a gap in sidewalk on the north and south sides of 100th way southeast directly in front of the school and to the east and west respectively. This project will tie into existing sidewalk and provide ADA compliant walkways along the roadways to eliminate the gaps.

Project Location See Location Map
 Construction Projects Type of Construction Project Pedestrian Improvements Project
 Length/Size of Construction Project _____
 Programs/Services Delivery Area of Program/Service Local Transportation Safety Program
 Duration of Program/Service 6 months

Identify project phases and costs
 Construction Projects Preliminary Engineering/Design: Phase Cost
 (mark the appropriate phase and enter cost) Right-of-Way: \$ 0
 Construction: \$ 479710
 Program or Operational Element Program or Operations Cost: \$ 0
 Costs Other Cost: \$ 0
 Total Project Cost (Sum of all project phase costs identified above): \$ 479710

FFY 2017 – 2019 Project Obligation
 Select the preferred federal fiscal year the project will obligate*
 Select an alternate federal fiscal year the project could obligate

	2017	2018	2019
Select the preferred federal fiscal year the project will obligate*	<input type="checkbox"/>	<input checked="" type="checkbox"/>	<input type="checkbox"/>
Select an alternate federal fiscal year the project could obligate	<input type="checkbox"/>	<input type="checkbox"/>	<input checked="" type="checkbox"/>

*Applicants are expected to obligate their project on time, as stated on this application and indicated on the award letter, if the project proposal is selected.

Federal Funding Request and Match (non-federal share)
 From Project Applicant* Local funding or other sources \$ 64761
 State funding \$ _____
 TAP Grant Request \$ 414949
 Total Project/ Phase Revenue \$ 479710

*Applicants must provide a minimum of 13.5% non-federal share to federal share.
Example
 Total Project Cost is \$100,000
 Minimum non-federal share: \$13,500
 Federal STP Funds: \$86,500

CA Agency and Representative Brian Moorehead (WSDOT Olympic Region)
 CA Signature and Date Brian Moorehead 10-21-16

Project Verification and Endorsement
 This project proposal reflects established local funding priorities consistent with the Regional Transportation Plan. Costs represent accurate planning level estimates needed to accomplish the work described herein. The project described is financially feasible, and local match revenue identified above is available and will be committed to the project if it receives the requested TAP grant. If selected, the project will obligate funding in Federal Fiscal Year 2016, prior to August 1, 2016. Failure to do so will result in loss of funding for the project. I realize that the use of federal funds for this project entails administrative and project compliance requirements over which TRPC has no control, and for which this agency or organization will be responsible.

This project has the full endorsement of the governing body/leadership of this agency or organization.

Chad Bedlington, PW Director
 Name and Title of Designated Representative

Chad Bedlington
 Signature of Designated Representative

10/27/16
 Date

Project Title: Fort Stevens Elementary - Pedestrian Improvements

SUPPORT FOR RECOGNIZED REGIONAL INITIATIVES

Identify any ways in which the proposed project supports existing regional initiatives. Examples of such initiatives include, but are not limited to, Sustainable Thurston, Urban Corridor Communities, Walk and Roll, Healthy Kids Safe Streets, Thurston Thrives, Commute Trip Reduction.

The proposed sidewalk promotes pedestrian and student safety systems. Because the project connects sidewalks and walking paths for pedestrians and students in the vicinity of Fort Stevens Elementary, it promotes safe routes to schools. The project promotes walking and policies relating to a direct, safe, interconnected pedestrian and student network providing pedestrian crossings and developing direct connections to the school.

PROJECT DESCRIPTION & SIGNIFICANCE (2 PAGES MAX, 10 POINT FONT MINIMUM)

Using the space provided on pages 3 and 4 below, please address the following in your narrative: Describe the proposed project and why it is a regional funding priority, paying particular attention to benefits the proposal will deliver. Consider all modes of travel in your description. Identify any collaboration or partnership with other entities with a vested interest in this project. Note whether this project leverages previous work, such as an implementation phase of a previous study or design phase, or whether it lays the groundwork for subsequent implementation phases. Describe any efforts that will help ensure this project can meet its obligation commitments. Indicate how this proposal supports the goals and policies of the Regional Transportation Plan, the transportation initiatives in Sustainable Thurston, or other adopted community plans and goals.

City staff worked directly with the Yelm School District to evaluate the projects proposed improvements and determine the underlying benefits to the school and surrounding neighborhoods. This project was first added to the City's 6-year TIP in 2015 as a potential project to fill gaps in our pedestrian and school infrastructure. That process included a public comment period prior to a resolution to adopt the TIP, presentation to City Council for annual adoption of the TIP and taking public comment at City Council Meetings.

From the school officials, there is a total of 568 students at the school and there are 219 students listed for walking which is also the number of children that live within 1-mile of the school that are not accounted for in bus or bike trips. Currently the School District is required to provide bus service to area students within the 1-mile area as pedestrian routes around the school are designated as hazardous routes without completion of a sidewalk network to access the school. This project would alleviate that issue and also reduce bus service and operating costs to the school district.

The Grove Rd construction area is outside of the City limits and the County has agreed to support the project. A supporting e-mail has been attached to this application for reference. A previous submittal for the Safe Routes to School Program was completed for this project for design funds only. If that grant is approved no design funds for this TAP application are required. The SRTS application is attached at the end of this application. Should SRTS design funding not be granted for this project, the City shall provide local match to complete engineer/permitting. City staff will conduct project management and primary construction engineering for this project to further defray engineering costs on the project.

This project has a particular emphasis on children walking to schools and intersection safety. It applies specifically to this project and supports 1a, 1l, 2a, 2b, 2d, 3a, 3b, 3c, 4c, 4e, 5b, 6a, 6b, 7a, 9c, 9d, 9g, 10f, 10g, 10i, 12a, 12b, 12d, 12f, 16b, 18e, and 18h of the 2040 Regional Transportation Plan goals and policies.

The project includes the construction of curb, gutter and 6-foot wide cement concrete sidewalk with planter strip from the existing sidewalk on the north sides of 100th St SE connecting to the Grove Rd SE on the north side and to the Fort Stevens Elementary on the south side via two crossings located to match existing walking path and sidewalk access points to the school grounds. The existing walking path leading into the school will be maintained. New sidewalk will connect to existing sidewalk along the west side of Grove Rd SE from approximately 200'-north of the intersection of 100th Ct SE & Grove Rd to 101 Way SE & Grove Rd and tie into the north side of 100th Way SE. A stormwater conveyance, water quality and infiltration system will be installed within ROW and shoulder area just west of Harold Ct. At the connection from Harold Ct and the bend at 100th St SE and 100th Way SE, RRFB crossing will be installed for added visibility and safety. This project includes ADA compliant curb ramp retrofits.

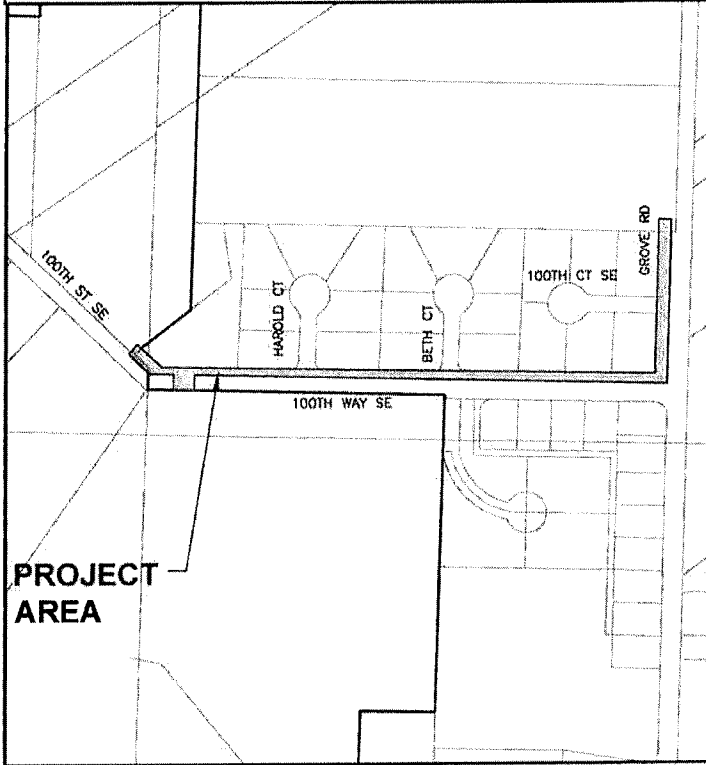
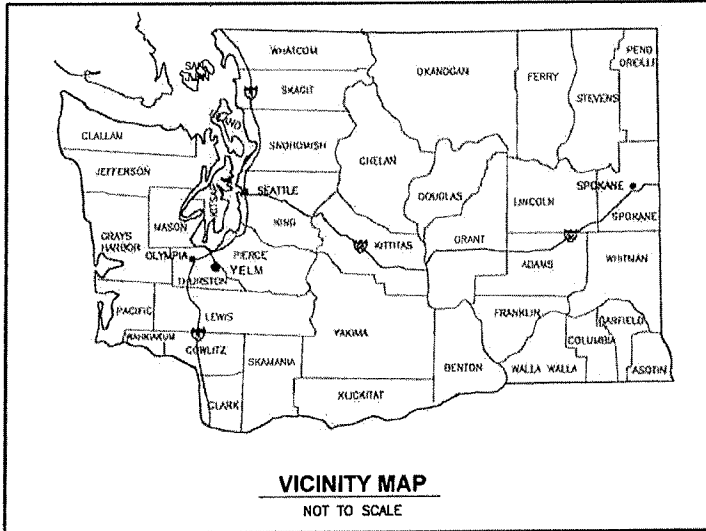

PROJECT LOCATION MAP
FORT STEVENS ELEMENTARY PEDESTRIAN
IMPROVEMENTS PROJECT

G&O PROPOSAL #20186.39



Gray & Osborne, Inc.
CONSULTING ENGINEERS

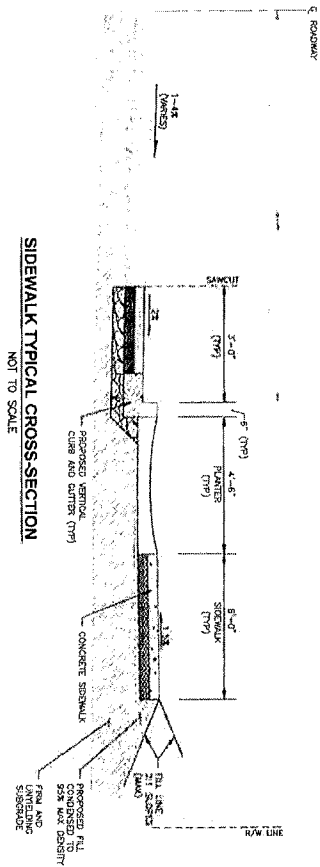

SIDEWALK TYPICAL CROSS-SECTION
NOT TO SCALE

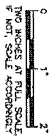

DATE: 08/25/2010	SHEET: 4
PROJECT: FORT STEVENS ELEMENTARY PEDESTRIAN IMPROVEMENTS	OF: 4

CITY OF YELM
KING COUNTY WASHINGTON
FORT STEVENS ELEMENTARY PEDESTRIAN IMPROVEMENTS PROJECT
TYPICAL CROSS SECTION

NO.	REVISION	DATE	APPRO
-----	----------	------	-------

PRELIMINARY NOT FOR CONSTRUCTION

DATE: AUG 2010	SCALE: NOTED
DRAWN: C.H.T.	CHECKED: C.M.T.
APPROVED: B.L.S.	

Gray & Osborne, Inc.
CONSULTING ENGINEERS
701 DOVER AVENUE NORTH SUITE 200
SEATTLE, WASHINGTON 98108 • (206) 284-0550

CITY OF YELM
Fort Stevenes Pedestrian Improvements
G&O #20166.39

PRELIMINARY COST ESTIMATE
8/11/2016

<u>NO.</u>	<u>DESCRIPTION</u>	<u>QTY</u>	<u>UNITS</u>	<u>UNIT PRICE</u>	<u>AMOUNT</u>
1	SPCC Plan	1	LS	\$ 1,000.00	\$ 1,000.00
2	Mobilization, Cleanup and Demobilization	1	LS	\$ 40,000.00	\$ 40,000.00
3	Project Temporary Traffic Control	1	LS	\$ 25,000.00	\$ 25,000.00
4	Clearing and Grubbing	1	LS	\$ 5,000.00	\$ 5,000.00
5	Removal of Structure and Obstruction	1	LS	\$ 2,500.00	\$ 2,500.00
6	Locate Existing Utilites	1	LS	\$ 500.00	\$ 500.00
7	Crushed Surfacing Top Course	80	TON	\$ 36.00	\$ 2,880.00
8	Crushed Surfacing Base Course	160	TON	\$ 36.00	\$ 5,760.00
9	Planing Bituminous Pavement	300	SY	\$ 7.00	\$ 2,100.00
10	HMA CI 1/2" PG 64-22	100	TON	\$ 100.00	\$ 10,000.00
11	Storm Conveyance and Infiltration Systems	1	LS	\$ 150,000.00	\$ 150,000.00
12	Adjust / Relocate Existing Utilities and Structures	1	LS	\$ 20,000.00	\$ 20,000.00
13	Erosion/Water Pollution Control	1	LS	\$ 10,000.00	\$ 10,000.00
14	Top Soil, Type A	100	CY	\$ 35.00	\$ 3,500.00
15	Bark or Wood Chip Mulch	70	CY	\$ 10.00	\$ 700.00
16	Cement Conc. Traffic Curb and Gutter	1800	LF	\$ 22.00	\$ 39,600.00
17	Cement Conc. Sidewalk	1120	SY	\$ 50.00	\$ 56,000.00
18	Cement Conc. Curb Ramp	9	EA	\$ 1,500.00	\$ 13,500.00
19	Remove and Relocate Fence	100	LF	\$ 80.00	\$ 8,000.00
20	Permanent Signing	1	LS	\$ 30,000.00	\$ 30,000.00
21	Channelization Improvements (8-22.5)	1	LS	\$ 10,000.00	\$ 10,000.00
Subtotal, All Items					\$ 436,100.00
Contingency (10%)					\$ 43,610.00
No Sales Tax, per Revenue Rule 171					0.00%
Total Estimated Construction Cost					\$ 479,710.00
Construction Management (15%)					\$ 71,956.50
Total Design and CM					\$ 71,956.50
TOTAL					\$ 551,666.50

Notes:

New Cement Conc. Curb Gutter and Sidewalk on one side of the street
Connect at the existing school walkway entrance
No Existing Curb and Gutter
Section description - 4.5' planter, 6' sidewalk, 2 ft HMA replacement at curb
Landscaping - 4" topsoil with seeding in planter - 2' Bark mulch behind new sidewalk
12 New sidewalk ramps / retrofits
Signing and Channelization includes removal of existing markings
Assumed No Right-of-Way required
Storm Improvements include CB's, Pipes, WQ and Infiltration Gallery
Prepared By: Cory N. Taylor, EIT
Checked By: Tani Stafford, P.E.

Cory Taylor

From: Scott Davis <davissa@co.thurston.wa.us>
Sent: Tuesday, April 19, 2016 7:17 AM
To: Chad Bedlington
Cc: Cory Taylor; Scott Lindblom
Subject: RE: Yelm SRTS application - Fort Stevens Elementary

Chad

Thurston County does not have a specific project currently identified for this area. Although in general terms we do have a safe routes to school program and bike/pedestrian program on our Capital Plan Facilities Plan that are intended to capture bike/ped/school projects as they arise for grant purposes, etc...The capital facilities plan can be viewed at - <http://www.co.thurston.wa.us/planning/cap-facilities-plan/docs/adopted-capital-facilities-plan-2016-2021.pdf>

Although Thurston County Public Works can/will support the City with this grant application we cannot at this time commit to it financially.

Please provide a copy of your completed application to me when you are done. We will add this site to our list of ped/bike candidate locations and priority array.

Thank you for letting us know of this project and hopefully you successful in obtaining design funds.

Regards

Scott Davis, PE
Traffic Engineering & Operations Manager
Thurston County Public Works
360-867-2345
davissa@co.thurston.wa.us

From: Chad Bedlington [mailto:chadb@ci.yelm.wa.us]
Sent: Thursday, April 14, 2016 12:01 PM
To: Scott Davis <davissa@co.thurston.wa.us>
Cc: Cory Taylor <ctaylor@g-o.com>
Subject: Yelm SRTS application - Fort Stevens Elementary

Hi Scott,

I am working with Gray and Osborne on a "design only" application to Local Programs for engineering some sidewalks and bike lanes for a safe routes to school project near and adjacent to Fort Stevens Elementary. Parts of the area to potentially benefit is located outside the City limits, include some of the possible ROW improvements. Generally we would want to extend sidewalk from the intersection of Middle Rd SE and 100th Wy SE, Easterly on both sides on 100th Wy SE from that point to the intersection with Grover Rd SE. Then extend sidewalk, curb and gutter, Northerly to the terminus of the existing sidewalk on Grove Rd SE just south of Greenleaf Ave SE (see attached map).

To your knowledge, does the County have any projects in a CIP or generally being considered for bike/ped in this area?