

Grand Mound Transportation Study

Grand Mound Chamber of Commerce

March 4, 2020



Overview



Grand Mound is growing.
Transportation infrastructure
needs to keep pace.

- Sources of Funding:
 - Federal Surface Transportation Program → WDOT
 - Thurston County Public Works

Project Timeline

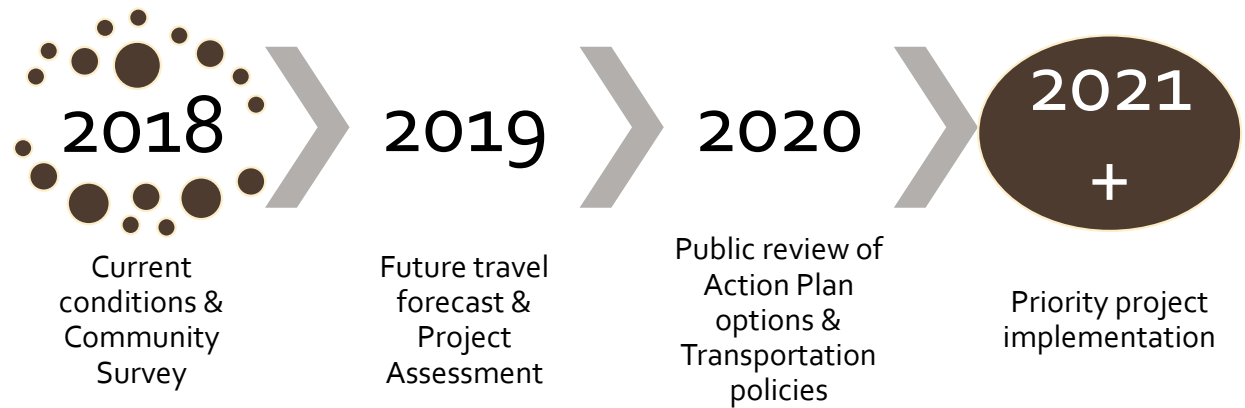

Current Conditions

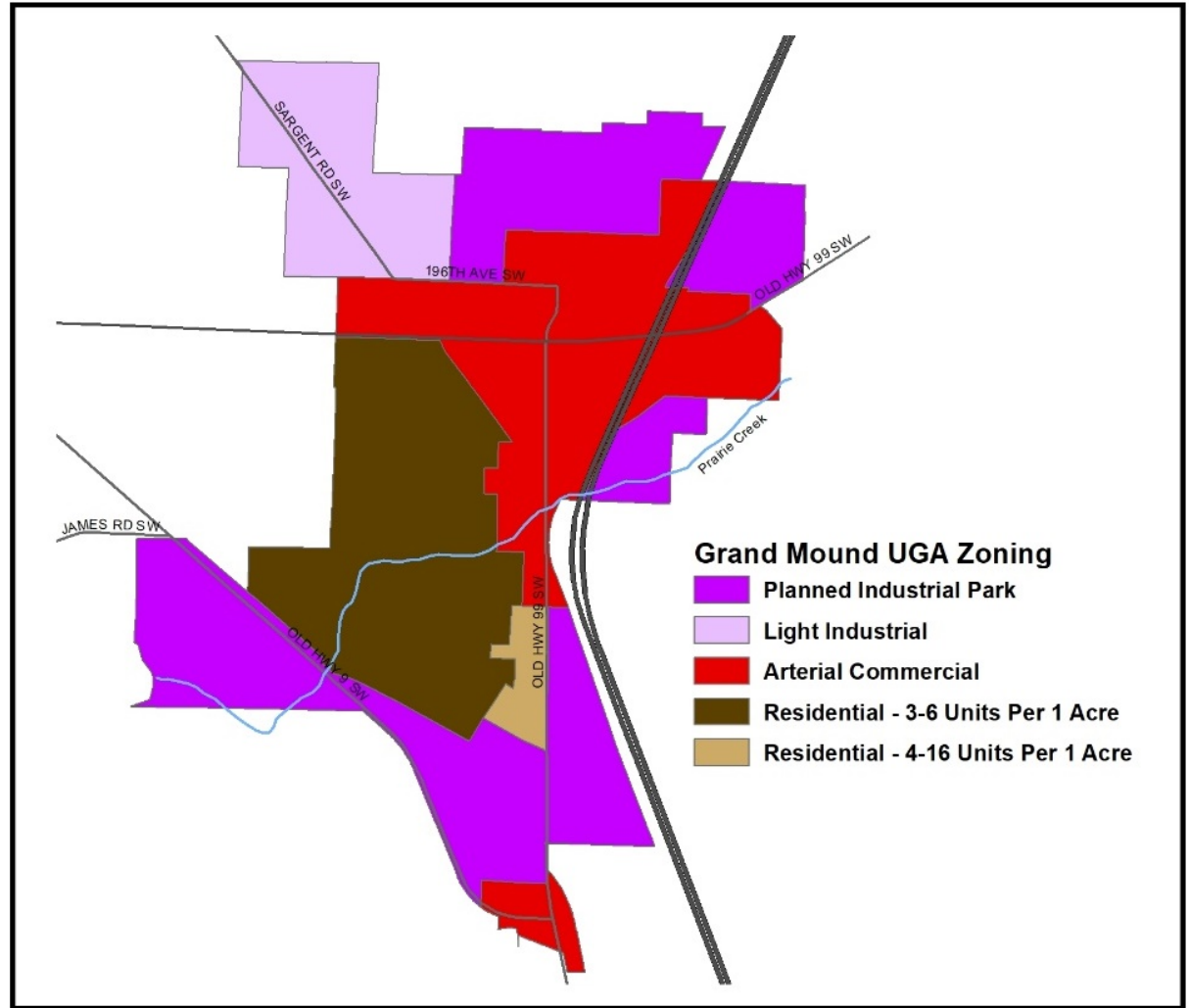

Current Conditions

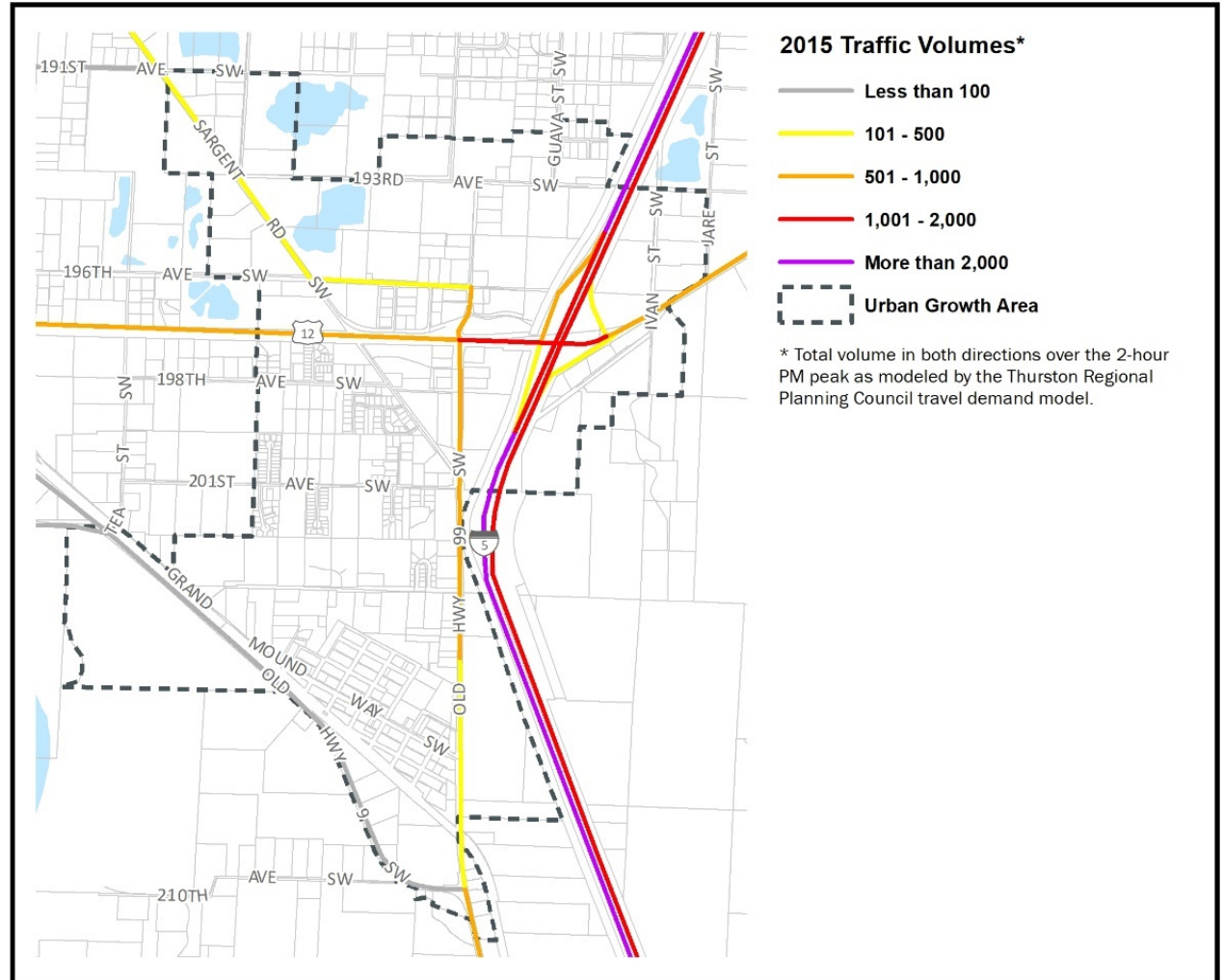

Current Conditions

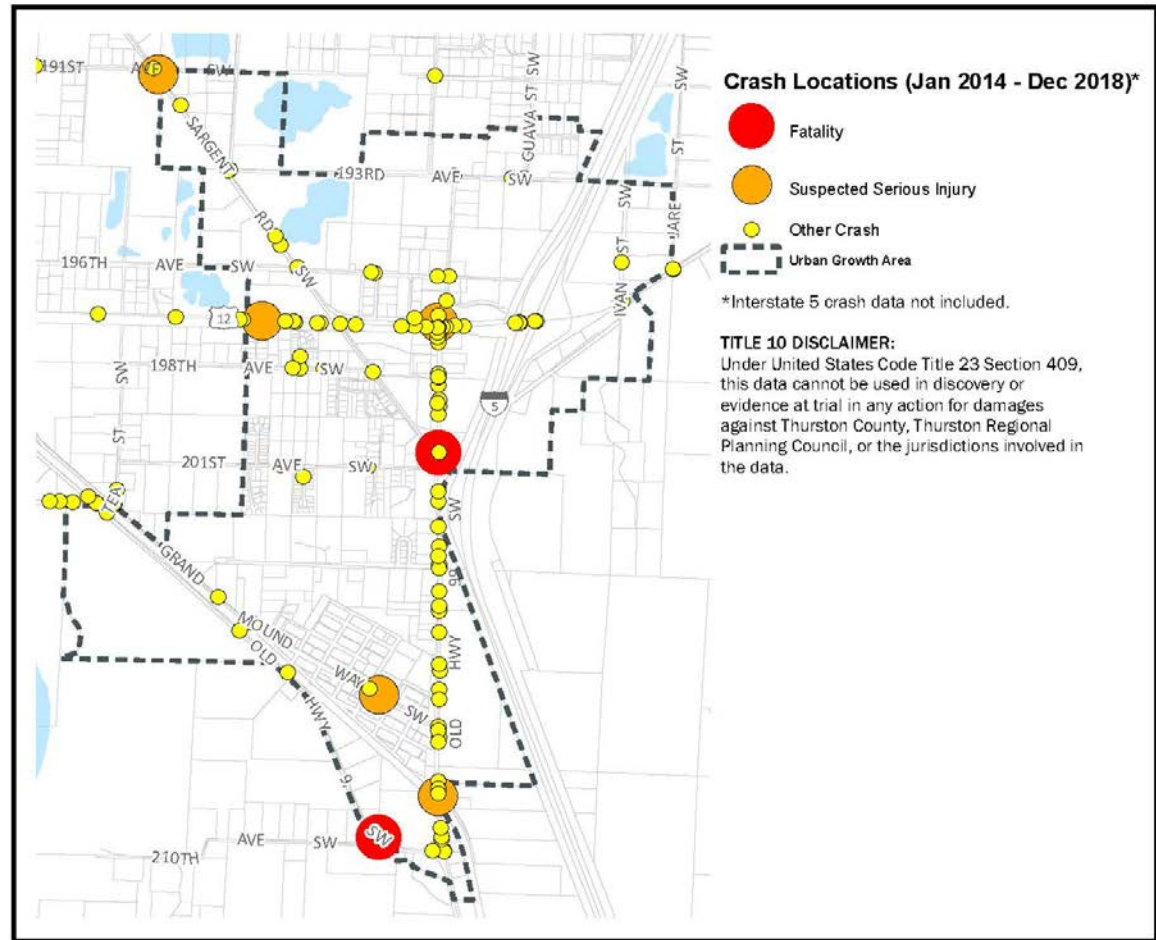

Current Conditions

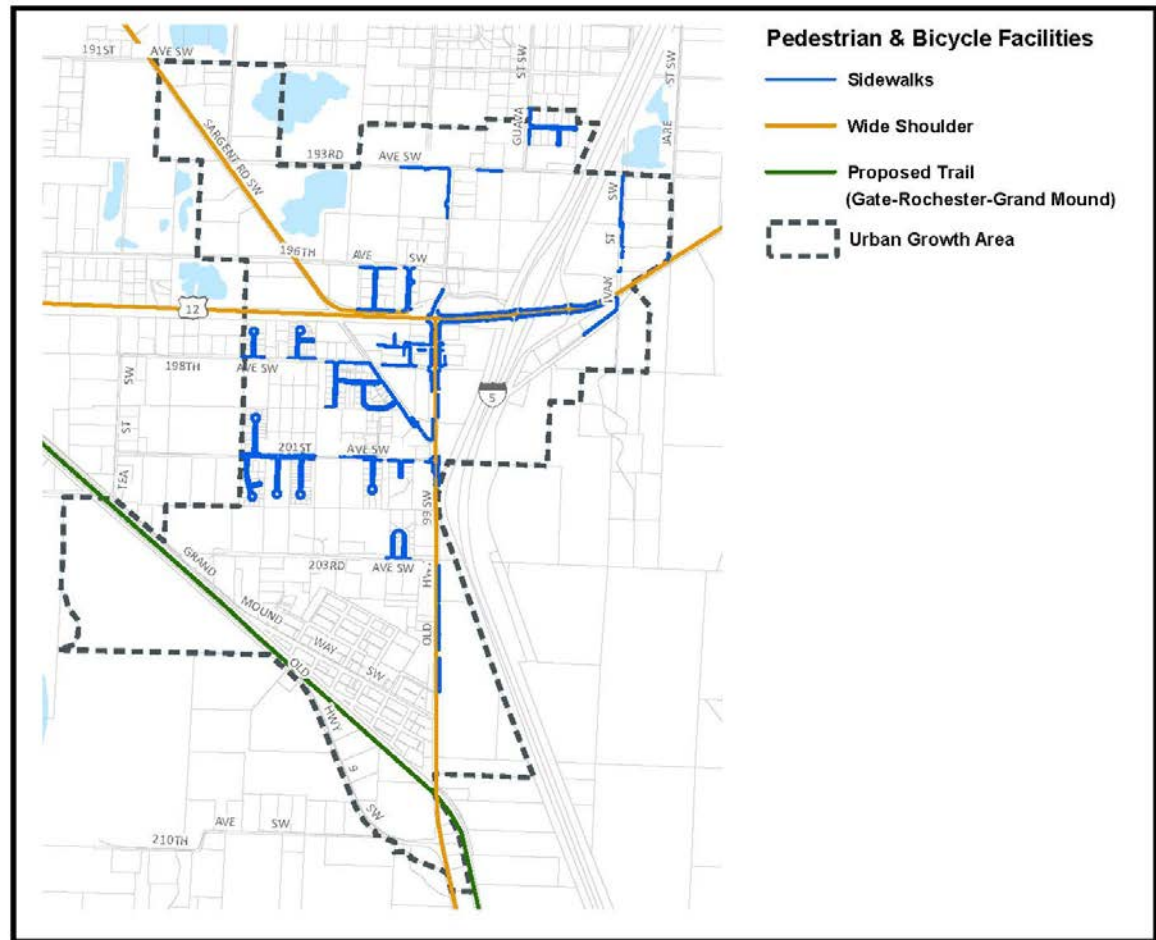

Community Outreach

Q5. How concerned are you about the following transportation issues in Grand Mound?

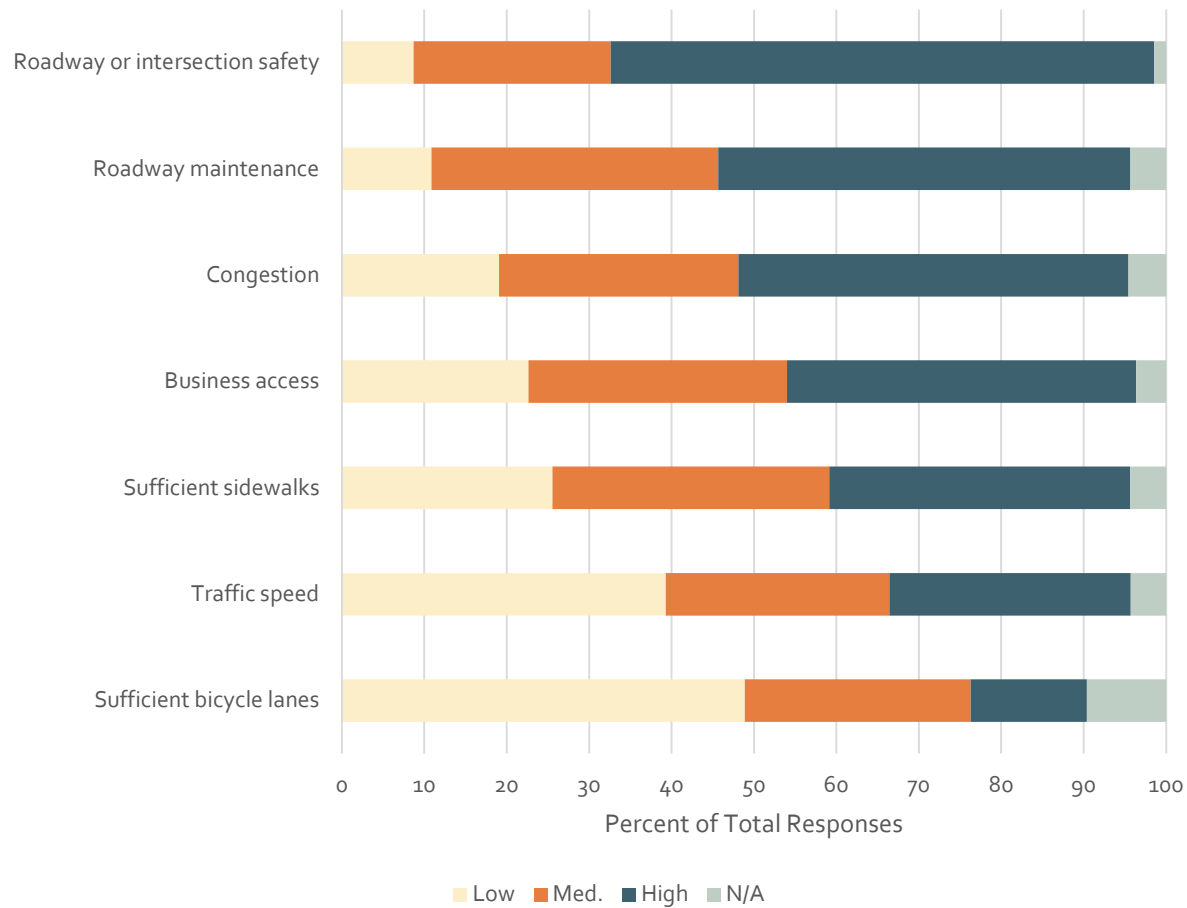

Draft Goals

- **Safety**
 - Transportation infrastructure in Grand Mound provides safe options for all users.
- **Efficiency**
 - Roadways and intersections have adequate capacity and function to avoid unacceptable levels of congestion for autos and freight, even as the region grows.
- **Character**
 - Transportation infrastructure contributes to Grand Mound's identity as a distinctive place with rural character.
- **Connections**
 - Grand Mound's transportation system accommodates walking and biking, including connections to regional trails, transit, and commercial land uses.
- **Economic Diversity**
 - Transportation facilities support economic growth in Grand Mound, including residential, commercial, jobs, and tourism.
- **Supported**
 - Transportation infrastructure in Grand Mound reflects community input.

Evaluated Projects

C1. 196th Avenue SW & Sargent Road SW Intersection Improvements

C3. 196th Avenue SW & Elderberry Street SW Intersection Improvements

C4. US 12/Old Highway 99/Elderberry Street SW Intersection Improvements

C7. Old Highway 99 Improvements

C8. Sargent Road Improvements

C10. Sargent Road SW /201st Avenue SW/ Old Highway 99 Intersection Improvements

C11. Old Highway 9 & Old Highway 99 Intersection Improvements

C13. Power Line Trail



C1. 196th Ave & Sargent Rd



C3. 196th Ave & Elderberry St



EXHIBIT DRAWING
FOR INFORMATIONAL
PURPOSES ONLY



TRPC
GRAND MOUND TRANSPORTATION STUDY
PROJECT NO. 20180283
FEBRUARY 12, 2020

C3 - 196TH AVE SW & ELDERBERRY ST SW
ROUNDBOUT LAYOUT

C4a. US 12, Old Highway 99 & Elderberry St

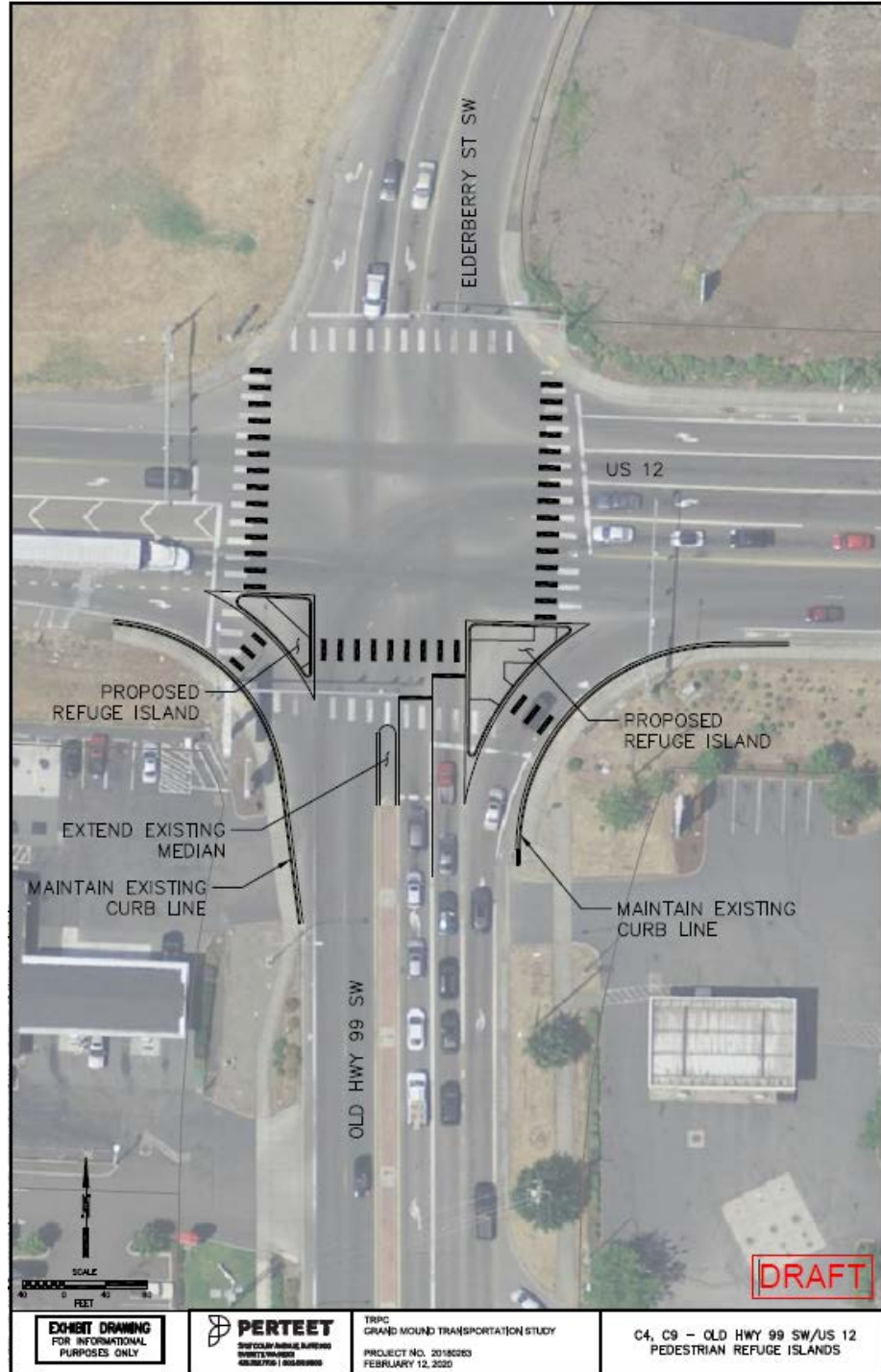

C4b. US 12,
Old Highway
99 &
Elderberry St



C4a. US 12, Old Highway 99 & Elderberry St

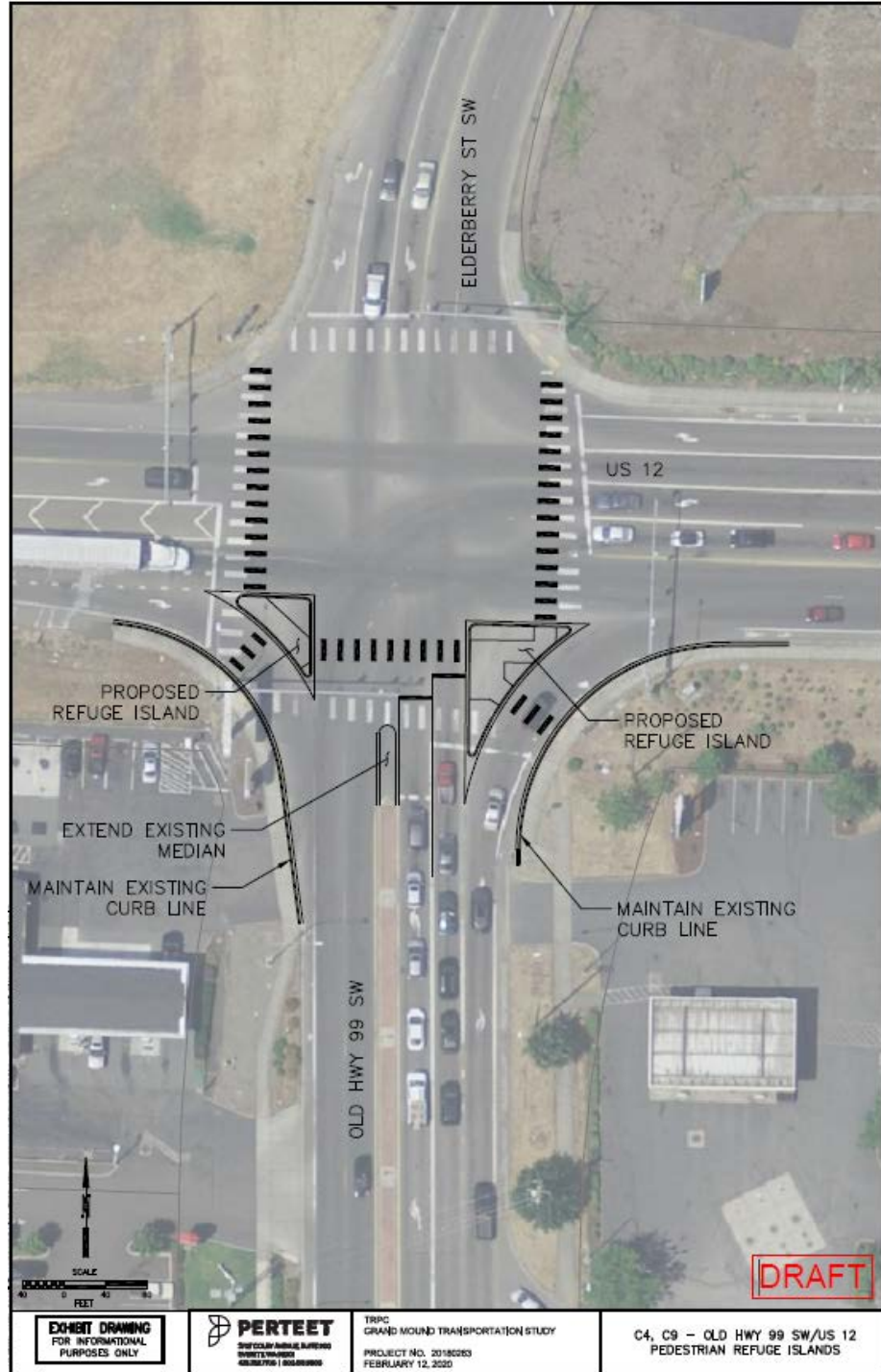

C7. Old Highway 99 cross section

C7: Old Highway 99 from US 12 to Old Highway 9

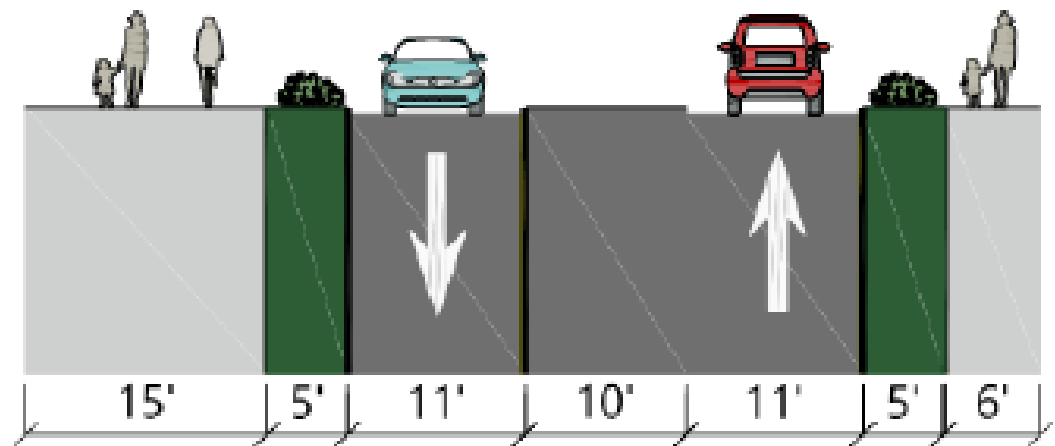

DRAFT

C8. Sargent Rd cross section

C8: Sargent Road

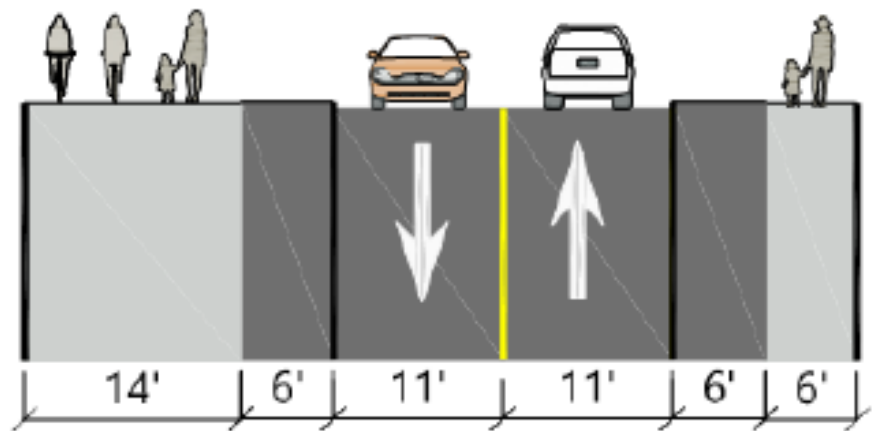

DRAFT

C10. Sargent Rd, 201st Ave, Old Highway 99

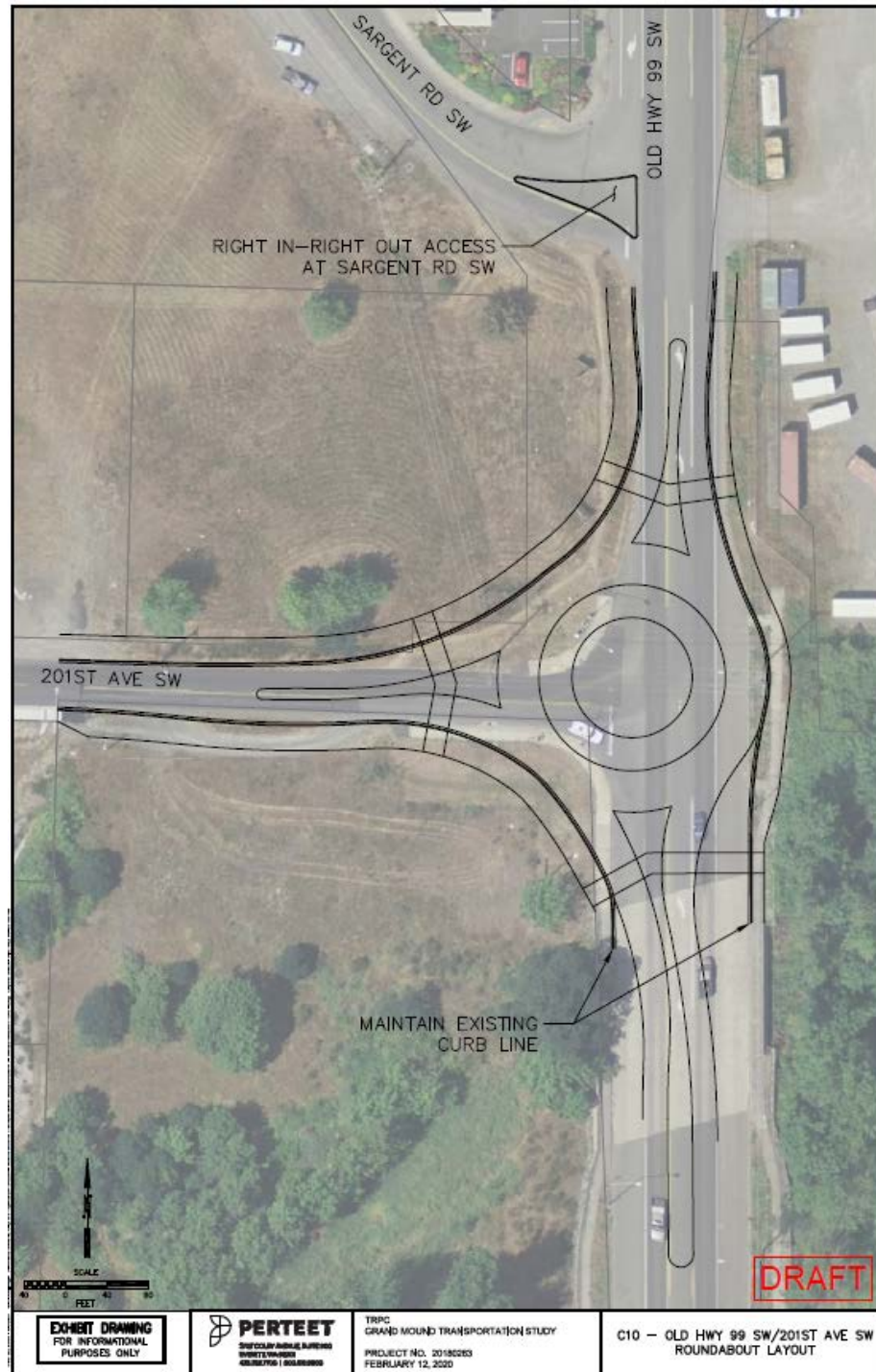

C11. Old Highway 99 & Old Highway 9



C13. Old Highway 99 & Old Highway 9



Next Steps

Spring 2020	Public outreach on top projects
Mid-2020	Draft plan and policies
2021+	County adds to Capital Facilities Plan and construction schedule

CONTACT

Allison Osterberg

- Senior Planner, Thurston Regional Planning Council
- (360)956-7575
- osterberga@trpc.org
- Project website: <https://www.trpc.org/1003/Grand-Mound-Transportation-Study>

