

2020 Rural Community Support Program (RCSP) Application



1. PROJECT TITLE		Elder Services Facility	
2. APPLICANT			
Community	Nisqually Indian Tribe		
Contact Person	Joe Cushman		
Phone Number	360-456-5221 ext. 1112	Email Address	cushman.joe@nisqually-nsn.gov
3. PROJECT CO-SPONSOR (Leave blank if not applicable)			
Co-Sponsor			
Contact Person			
Phone Number		Email Address	
4. PROJECT OVERVIEW			
Provide a brief description of the proposal. State the problem and need, how the proposal addresses the need, and the anticipated benefits to the community. (~150 words)			
<p>The RCSP grant will be used to supplement other grant funds the Nisqually Indian Reservation is seeking to construct a new Elders Center. The new Elders Center is will be collocated with a new Health Clinic that is currently under construction. Siting these facilities close to a new multi-family residential housing area moves the Nisqually Indian Reservation closer to its vision to consolidate its major community destinations and services on the north side of State Route 507. The Elders Center design includes sidewalks and pathways to provide safe and convenient walking routes for Tribal residents accessing these community facilities and services. The RCSP grant will fund a portion of these future pedestrian improvements.</p>			
5. PROJECT TYPE (Mark all that apply)			
a.	Construction, reconstruction, preservation, resurfacing, restoration, or operational improvements of highways, bridges, and tunnels		<input type="checkbox"/>
b.	Intersection operational improvements		<input type="checkbox"/>
c.	Electric and alternative fuels vehicle infrastructure		<input type="checkbox"/>
d.	Active transportation projects such as bicycle and pedestrian facilities, including sidewalks, bicycle lanes, trails, and street crossing improvements		<input checked="" type="checkbox"/>
e.	Modification of sidewalks to comply with Americans with Disabilities Act		<input type="checkbox"/>
f.	Projects that promote health and make the regional trail system more convenient to use such as trailhead improvements, seating, restrooms, wayfinding signage, bicycle racks, and kiosks		<input type="checkbox"/>
g.	Safe Routes to School Program		<input type="checkbox"/>
h.	Environmental mitigation		<input type="checkbox"/>
i.	Roadway/street safety projects, hazard eliminations, railway/highway grade crossings		<input type="checkbox"/>
j.	Other_____		

6. SUMMARY DETAILS (complete the section that best matches your project type)			
CONSTRUCTION PROJECT			
Project Location	12310 Yelm Highway SE, Olympia, WA 98513		
Limits			
Project Length	3 years (estimated)		
STUDIES OR PROGRAMS			
Location			
Duration			
7. REGIONAL FUNDING PRIORITIES			
What Regional Funding Priority does this proposal promote?			
<input type="checkbox"/>	Safety – Projects that enhance the safety of all who use, operate, or maintain the transportation system		
<input type="checkbox"/>	Maintenance and Preservation – Projects that protect existing transportation system investments and keep life-cycle costs as low as possible		
<input type="checkbox"/>	Multimodal and System Efficiency – Projects that integrate multimodal facilities and/or include Transportation Demand Management elements to support adopted land use plans and encourage transit, share ride, walking, and cycling. Also includes projects that improve the operating efficiency of the system.		
<input checked="" type="checkbox"/>	Active Transportation – Projects that make shared-use trails or community destinations more convenient and compelling to use for walking, bicycling, running, or other forms of active travel that promote health.		
8. FUNDS FOR PROJECT COMPLETION			
8a. Does this project rely on other sources of funding or other grant programs? <input checked="" type="radio"/> Yes <input type="radio"/> No			
8b. If yes to question 10a, will the funds requested in this proposal allow the applicant to successfully complete the project? <input type="radio"/> Yes <input checked="" type="radio"/> Other phases will require additional funding			
9. PROJECT PHASING AND COSTS			
Select the applicable project phases and enter applicable costs.			
		Cost	
CONSTRUCTION	Preliminary Engineering/Design	<input type="checkbox"/>	\$
	Right-of-Way	<input type="checkbox"/>	\$
	Construction		\$137,500.00
STUDIES, PROGRAMS, OR OTHER	Planning, Study, or Program/Services	<input type="checkbox"/>	\$
	Other	<input type="checkbox"/>	\$
Total proposed cost (Sum of all phases identified above)			\$137,500.00
10. GRANT FUNDING REQUEST AND MATCHING REVENUES			
Local funding or other sources (match is not required)			\$
Grant Request			\$137,500.00
Total Project Revenue			\$137,500.00
11. MATCHING FUND DETAILS - OPTIONAL			
11a. MATCH SOURCE—List the source, status, and amount of all matching funds.			
Source of Funds	Current Status (secure or unsecure)	Amount	
Dept. of Commerce (pending)		\$3,500,000.00	
		\$	

11b. MATCH TIMING LIMITATIONS—Do any matching funds pose limitations on the timing of the proposed project?
 Yes No If yes, please provide comments below.

Comments on matching fund limitations, if applicable.

12. CONSTRUCTION AND RIGHT-OF-WAY PROJECT READINESS

12a. DESIGN COMPLETENESS (enter completed or target completion dates)
 Preliminary Engineering

12b. RIGHT-OF-WAY COMPLETENESS. Use the space below to provide additional details, if necessary.

Right-of-Way is not required

Right-of-Way acquisition (enter completed or target completion dates)

Use the space below to provide any relevant right-of-way information.

The project property is under Nisqually tribal ownership.

13. PROJECT DESCRIPTION DETAILS

13a. SCOPE OF WORK— Succinctly describe the overall scope of the project: **1) For construction projects**— include all the types of transportation facilities and infrastructure the project will address and the proposed phase deliverables and the anticipated deliverables when fully completed; **2) For plans or studies**, clearly state the study objectives and how they will be achieved; **3) For programs and services**, describe the activities and desired outcomes (~300 words).

This project will sit on 4.5 acres and implement walking paths and a complete street to reduce the possibility of pedestrian accidents and harm. Parking is estimated to provide one stall for every 350 square feet of the building, with the shortest car-to-entrance route designated for the disabled and elders with limited mobility. Upon completion, the Nisqually elder community will have a facility that provides adequate space for socialization, improved meal programs, a culturally relevant atmosphere, and a place where community elders can be well cared for and comfortable. The Elders Center design includes a network of new sidewalks and pathways that will connect to the new Health Clinic and nearby residential neighborhood. The RCSP grant funding will be used to construct a portion of the sidewalks that will provide safe and convenient routes for Tribal members to walk between these important community destinations.

14. EQUITY

14a. **ADVANCING TRANSPORTATION EQUITY** — How does this proposal advance the transportation needs of people in your community who may experience challenges or barriers that could be attributed to their race/ethnicity, age, physical ability, or income? Consider those who lack access to personal vehicles (~150 words).

The facility will allow for multiple spaces where elders can interact with peers and participate in cultural activities that are typically held elsewhere. The facility will also provide amenities so elders will not have to travel off the reservation to enjoy. The building's proximity to the medical center provides easy access to services.

15. ENVIRONMENTAL SUSTAINABILITY

15a. **DESIGN ELEMENTS**—Does the project mitigate or minimize the environmental impacts of the project beyond current design standards? Check all that apply. Use the 'Other' box below to provide additional details, if relevant.

- Does not apply
- Low Impact Development Best Management Practices
- Use of drought resistant vegetation/landscaping
- Includes terrestrial or stream or wetland habitat restoration (such as fish passage barrier removal)
- Flood mitigation
- Use of in-place recycling materials
- Use of LED lighting
- Use of solar-powered lighting or signage
- Installation of electric vehicle charging infrastructure or alternative fuel support systems
- Other (describe other sustainability benefits or use the space below to provide additional details for any elements checked above).

16. MULTIMODAL ACCESSIBILITY

16a. **SYSTEM USERS**—Describe how the project will enhance travel choices. Who are the users and how will they benefit? (~150 words).

The building will be situated in a more residential area with actual sidewalks and away from the major highway. There will also be paths and walkways that elders can safely use for exercise or leisure. Facility employees and medical staff can easily access, treat, and interact with elders or other necessary persons as needed.

16b. NETWORK CONNECTIVITY—Detail how the project will provide greater network connectivity and describe which modes of travel will be affected. (~150 words)

The power and communication lines will be extended to the facility to ensure direct and sufficient connectivity. The current plans for this extension will not impact travel options.

17. SYSTEM EFFICIENCY

17a. Identify applicable system efficiency benefits this project will produce (mark all that apply). Use the 'Other' box below to provide additional details, if relevant.

- Travel time reduction
- Congestion reduction
- Reduced vehicle miles traveled
- Reduced greenhouse gas emissions
- Operational cost reductions
- Maintenance cost reductions

Other (describe other direct efficiency benefits or use the space below to provide additional details for any elements checked above ~150 words).

The new location eliminates most interaction with any traffic from adjacent towns and the Nisqually Red Wind Casino. The direct benefit is increased elder safety, reduced vehicle use, and a decrease in delayed or missed appointments located on the tribe.

18. ECONOMIC VITALITY

18a. ECONOMIC DEVELOPMENT— If applicable, describe how the project supports other economic development objectives as described in your Comprehensive Plan or other strategic planning document (~150 words).

This project one of the many projects that aim to enhance tribal land development as outline in Nisqually's 20 year community development strategy. This strategy includes projects such as this which will improve services for a specific demographic while making strategic investments that increase the tribe's viability.

18b. **COMMUNITY CO-BENEFITS**— If applicable, describe any co-benefits that are expected from this project such as community wellness and human health, quality of life, placemaking, climate adaptation or mitigation, or hazard mitigation. Please cite relevant local and regional planning documents, where appropriate (~150 words).

This project aligns with the tribe's goal of increasing the happiness, well-being, and cultural appreciation. This building will outlive current elders and offer a sense of relief, reliability, and sustainability for future elders. Specific components, such as the garden, allow for community engagement and cultural practices.

19. SAFETY

19a. **KNOWN SAFETY PROBLEM**—Does this project/program address a location with a known safety problem or include factors identified through a communitywide systemic risk assessment?

Yes No If yes, please complete questions 19b and 19c. If no, skip the remainder of question 20.

19b. **FACTORS**—Describe the conditions that contribute to the safety risks for the project location (~150 words).

19c. **COUNTERMEASURES**—Describe how the proposal will address the safety problems, including the types of countermeasures the project will implement (~150 words).

20. PRESERVATION AND MAINTENANCE

20a. What type of maintenance will the project perform? (If not applicable, skip this question).

- Chipseal
- Overlay
- Full depth reclamation
- Modification of sidewalk ramps to meet current ADA standards

Other (describe other preservation, maintenance, or replacement components included in the project or use the space to provide additional details for one of the elements checked above ~150 words).

21. OPTIONAL ATTACHMENTS

Note: The total number of attachments to support proposal should not exceed five pages.

Please identify any supplemental attachments that are included in your application.

- Vicinity Map
- Photographs
- Illustrations, cross-sections, or schematics
- Letter of Support
- Other _____

22. PROJECT VERIFICATION AND ENDORSEMENT

This project proposal reflects established local funding priorities consistent with the Regional Transportation Plan. Costs represent accurate planning level estimates needed to accomplish the work described herein. The applicant acknowledges that the use of Rural Community Support Program grant funds for this project entails administrative requirements that are established through an interlocal agreement with Thurston County, and for which this agency or organization will be responsible. This project has the full endorsement of the governing body/leadership of this community.

LEAD AGENCY AUTHORIZATION

Joe Cushman	
Name of Lead Agency Representative Authorized to Submit the Application	Title Planning Director
<input checked="" type="checkbox"/> I verify and endorse this proposal as stated in the preceding statement.	Date: 10/21/20 _____

CO-SPONSOR AUTHORIZATION (IF APPLICABLE)

Name of Co-Sponsor Representative Authorized to Submit the Application	Title
<input type="checkbox"/> I verify and endorse this proposal as stated in the preceding statement.	Date: _____

Nisqually Elders Center Site Plan

NISQUALLY ELDER'S CENTER
NISQUALLY INDIAN TRIBE
OLYMPIA, WA 98513

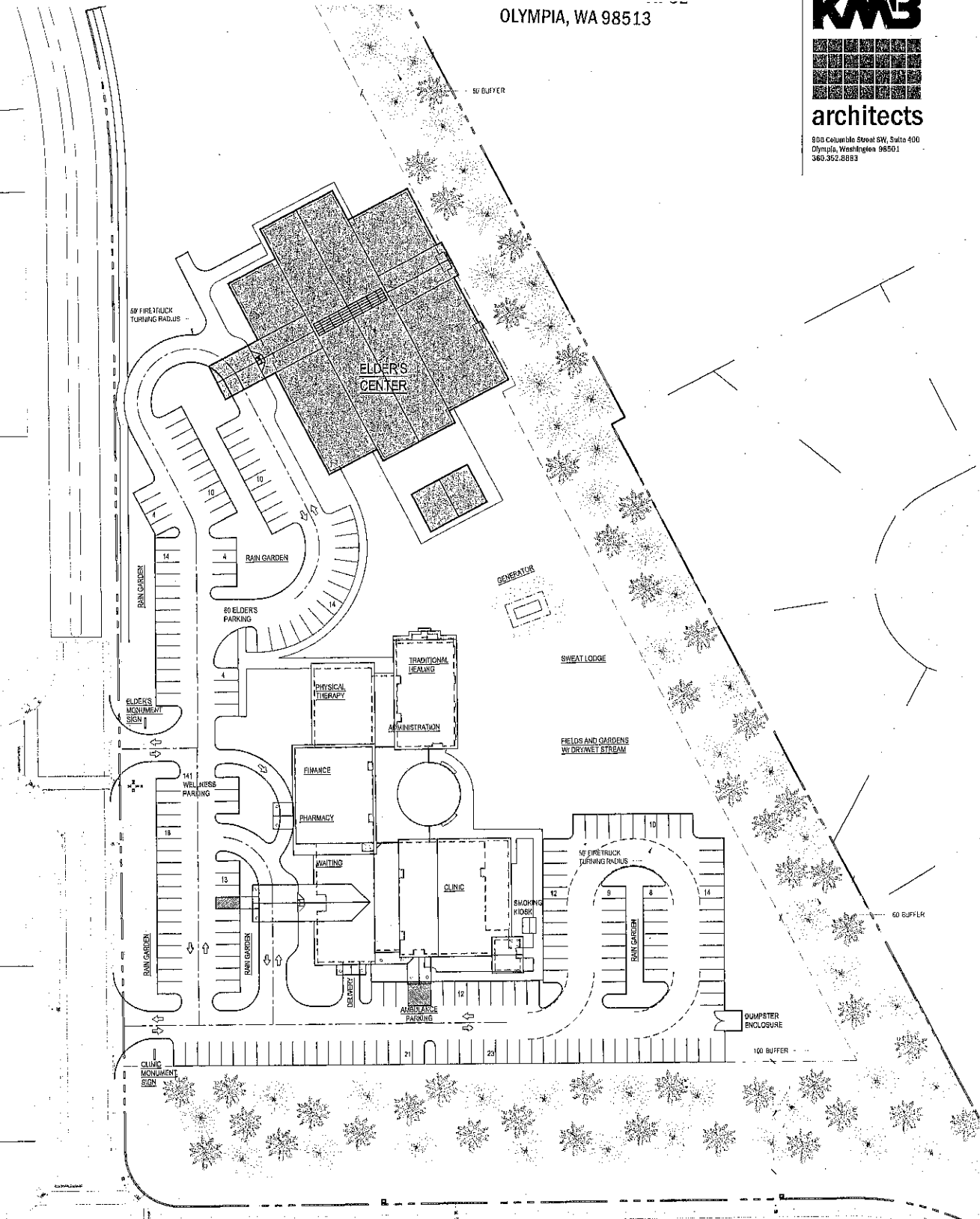

Nisqually Elders Center Location



Legend

- Parcel Boundaries
- Roads - Major
 - Major Roads
 - Ramp
 - I 5; US 101
- Roads (Large Scale)
- + Railroads
- County Border

Scale 1:17,016

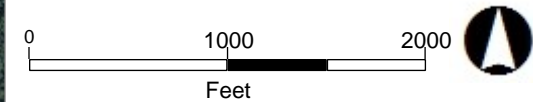

Map Created Using GeoData Public Website

Published: 8/24/2020

Note:



The information included on this map has been compiled by Thurston County staff from a variety of sources and is subject to change without notice. Additional elements may be present in reality that are not represented on the map. Ortho-photos and other data may not align. The boundaries depicted by these datasets are approximate. This document is not intended for use as a survey product. ALL DATA IS EXPRESSLY PROVIDED 'AS IS' AND 'WITH ALL FAULTS'. Thurston County makes no representations or warranties, express or implied, as to accuracy, completeness, timeliness, or rights to the use of such information. In no event shall Thurston County be liable for direct, indirect, incidental, consequential, special, or tort damages of any kind, including, but not limited to, lost revenues or lost profits, real or anticipated, resulting from the use, misuse or reliance of the information contained on this map. If any portion of this map or disclaimer is missing or altered, Thurston County removes itself from all responsibility from the map and the data contained within. The burden for determining fitness for use lies entirely with the user and the user is solely responsible for understanding the accuracy limitation of the information contained in this map. Authorized for 3rd Party reproduction for personal use only.